

# Deep Cycle Battery

Suits MotorGuide®

Order online at:



Battery is specially designed for frequent discharge deep cycle application. By using the specially designed active material, strong grids and thick plate construction, the battery offers reliable performance in high load situations.

## Specification

Cells Per Unit	6
Voltage Per Unit	12
Capacity	106 Ah@20hr-rate to 1.75V per cell @25°C
Weight	Approx. 30.0 Kg (Tolerance ±2%)
Internal Resistance	Approx. 5.5 mΩ
Terminal	F12(M8)F15(M6)
Max. Discharge Current	1000A (5 sec)
Cold Cranking Ampere(CCA)	620A
Maximum Charging Current	30.0 A
Reference Capacity	C3 77.4AH C5 87.5AH C10 100.0AH C20 106.0AH
Float Charging Voltage	13.6 V~13.8 V @ 25°C Temperature Compensation: -3mV/°C/Cell
Cycle Use Voltage	14.6 V~14.8 V @ 25°C Temperature Compensation: -4mV/°C/Cell
Operating Temperature Range	Discharge: -20°C~60°C Charge: 0°C~50°C Storage: -20°C~60°C
Normal Operating Temperature Range	25°C±5°C
Self Discharge	Fusion EV series batteries can be stored for up to 6 months at 25°C and then recharging is recommended. Monthly Self-discharge ratio is less than 3% at 25°C. Please charged batteries before using.
Container Material	A.B.S. UL94-HB, UL94-V0 Optional.



PART NUMBER : 8M8035105

## Dimensions

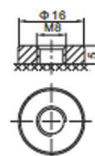
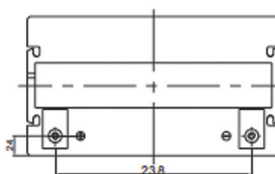
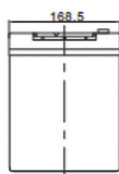
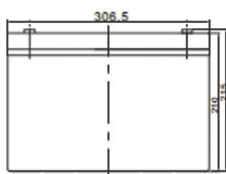

F12 Terminal

Length	306.5±2mm (12.1 inches)
Width	168.5±2mm (6.63 inches)
Height	210±2mm (8.27 inches)
Total Height	215±2mm (8.46 inches)
Terminal	Value
M5	6~7 N*m
M6	8~10 N*m
M8	10~12 N*m

Unit: mm